



105 Newport Road
Chorlton, Manchester, M21 9NW
Guide Price £595,000



105 Newport Road, Chorlton, Manchester, M21 9NW

This delightful house, built in 1911, offers a perfect blend of character and modern living. With three well-proportioned bedrooms, this property is ideal for families or those seeking extra space. The house features a welcoming reception room, providing a comfortable area for relaxation and entertaining guests.

One of the standout features of this home is its two bathrooms, which add convenience for busy households. The property has been immaculately kept, ensuring that it is ready for you to move in without the need for extensive renovations.

The south-facing garden is a true gem, allowing for plenty of sunlight throughout the day, making it an ideal spot for outdoor gatherings or simply enjoying a quiet moment in nature.

Situated close to local schools and a variety of amenities, this property is perfectly positioned for those who value community and accessibility. Whether you are looking for a family home or a peaceful retreat, this house on Newport Road is a wonderful opportunity not to be missed.



Area Map



Floor Plan

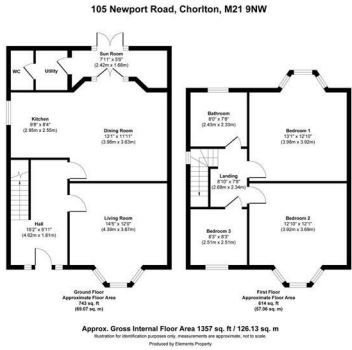

Energy Efficiency Graph

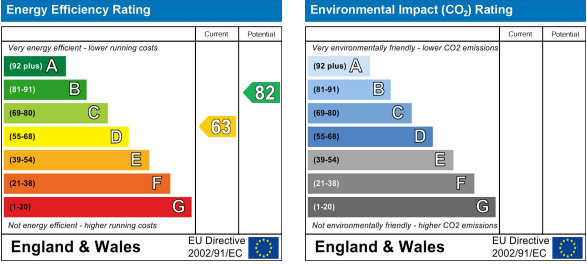

These particulars, whilst believed to be accurate are set out as a general outline only for guidance and do not constitute any part of an offer or contract. Intending purchasers should not rely on them as statements of representation of fact, but must satisfy themselves by inspection or otherwise as to their accuracy. No person in this firms employment has the authority to make or give any representation or warranty in respect of the property.

58 Beech Road, Chorlton, Manchester, M21 9EG

Tel: 0161 510 9555 Email: homes@LAPropertyDiscovery.co.uk www.LAPropertyDiscovery.co.uk