

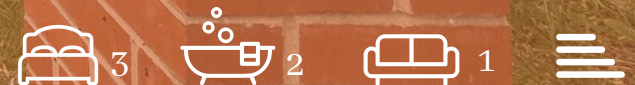

1B Athol Road  
Manchester, M16 8QW  
Guide Price £450,000



1B Athol Road, Manchester, M16 8QW

Located on Athol Road in Manchester, this delightful house offers a perfect blend of modern living and convenience. Built in 2003, the property has recently undergone a comprehensive renovation, ensuring that it meets the highest standards of contemporary comfort and style.

Inside, you will find a spacious reception room that serves as an inviting space for relaxation and entertainment. The house boasts three well-proportioned bedrooms, providing ample space for families or those seeking a home office. With two bathrooms, morning routines will be a breeze, catering to the needs of busy households.

One of the standout features of this property is its excellent transport links, making commuting to the city centre and beyond both easy and efficient. Whether you are travelling for work or leisure, you will appreciate the accessibility this location offers. Additionally, the convenience of off-road parking adds to the appeal, ensuring that you have a secure place for your vehicle.



Area Map



Floor Plan

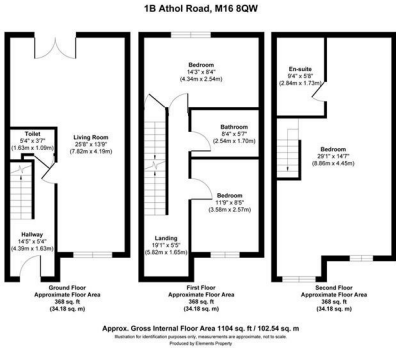

Energy Efficiency Graph

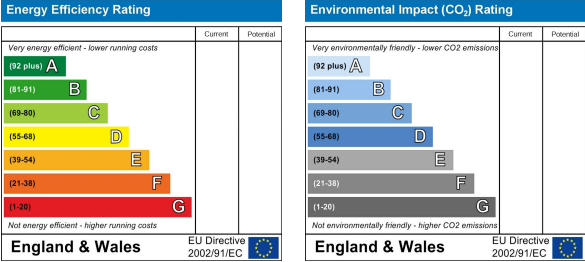

These particulars, whilst believed to be accurate are set out as a general outline only for guidance and do not constitute any part of an offer or contract. Intending purchasers should not rely on them as statements of representation of fact, but must satisfy themselves by inspection or otherwise as to their accuracy. No person in this firms employment has the authority to make or give any representation or warranty in respect of the property.

58 Beech Road, Chorlton, Manchester, M21 9EG

Tel: 0161 510 9555    Email: homes@LAPropertyDiscovery.co.uk    www.LAPropertyDiscovery.co.uk